

STECK

Esta é a sua marca.

1º Dígito - Nº de Pólos:

3 = 2P+T
4 = 3P+T
5 = 3P+T+N

3º Dígito - Tipo:

0 = Tomada de Sobrepor
4 = Tomada de Embutir
5 = Acoplamento
7 = Plug

Linha:

S = Brasikon
N = Newkon
S = Shock Tite

S 4 2 7 6

2º Dígito - Amperagem:

0 = 16A
2 = 32A
5 = 63A
6 = 125A
8 = 200A
9 = 250A**

4º Dígito - Tensão/ Posição Horária/ Cor

2 = 24V – 2h - Lilás
4 = 100/130V – 4h - Amarelo
9 = 200/250V – 9h* - Azul
6 = 380/440V – 6h* - Vermelho
5 = 600/690V – 5h - Preto
0 = Até 500Hz – 10h - Verde

*Quando 2P+T, inverter posição horária:

Tensão 200/250V – 9h passa para 6h

Tensão 380/440V – 6h passa para 9h

**250A, somente linha Shock Tite - 600/690V – 1h – Preto

***Linha Shock Tite, acrescentar **W** no final do código

Linha: Plugues e Tomadas Blindadas Brasikon® Newkon® Shock Tite® Surelock®

Tabela para Baixa Tensão

16A - 32A - 63A - 125A - 200A

Tensão de Utilização	Frequência Hz	Posição Horária					
		2P + T 16 e 32A 63 e 125A		3P + T 16 e 32A 63 e 125A		3P + N + T 16 e 32A 63 e 125A	
100 a 130	50 e 60	4	4	4	4	4	4
200 a 250	50 e 60	6	6	9	9	9	9
380 a 440	50 e 60	9	9	6	6	6	6
250 / 440	60					11	11
440	60			11	11		
500	50 e 60	7	7	7	7	7	7
600 a 750	50 e 60	5	5	5	5	5	5
Mais de 50	100 a 300	10	10	10	10	10	10
Mais de 50	de 300 a 500	2	2	2	2	2	2
De 50 a 250	Corrente Contínua	3	3				
Mais de 250	Corrente Contínua	8	8				



Tabela para Baixíssima Tensão 16A e 32A

Número de Pólos	Frequência Hz	Tensão V	Pino Terra em Horas	Cor
	50 e 60	20 a 25	-	Lilás
	50 e 60	40 a 50	12	Branco
2 e 3	de 100 a 200	até 50	4	Verde
	300	até 50	2	Verde
	400	até 50	3	Verde
	mais de 400 até 500	até 50	11	Verde
2	c.c.	até 50	10	Branco

Identificar Posição Terra pela Tomada (fêmea)

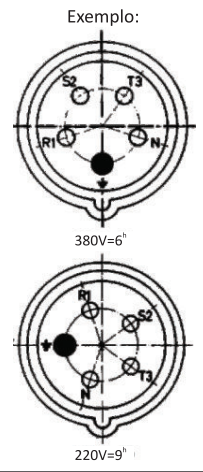
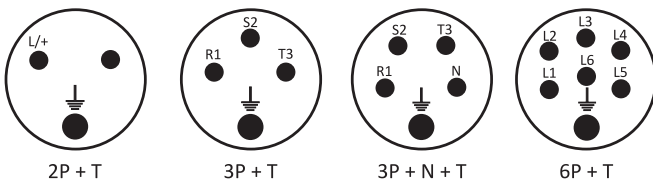

Tensão	Cor
20 e 25V	Violeta
40 a 50V	Branca
110 a 130V	Amarela
220 a 240V	Azul
380 a 440V	Vermelha
500 a 750V	Preta
Acima de 60 a 500 Hz	Verde

DISPOSITIVO ADICIONAL DE SEGURANÇA: Brasikon® Newkon® Shock Tite® Surelock®

As conexões 63, 125 e 200A podem ser fornecidas com contato piloto (opcional) na parte central. Este contato piloto fecha depois dos outros.

Ao retirar o plugue, este contato abre-se antes dos outros, evitando assim os perigos do arco elétrico. Para solicitar o contato piloto acrescentar a letra "P" após a referência do produto.

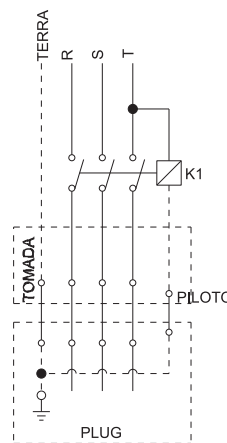

Exemplo de circuito de comando

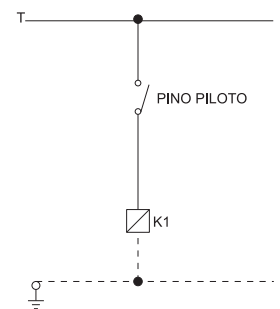

Obs:1- O pino piloto é o último a ser conectado e o 1º a ser desconectado.
2- A In do contator deve ser ≥ a da tomada.

Linha: Plugues e Tomadas Blindadas à Prova D'água Shock Tite®

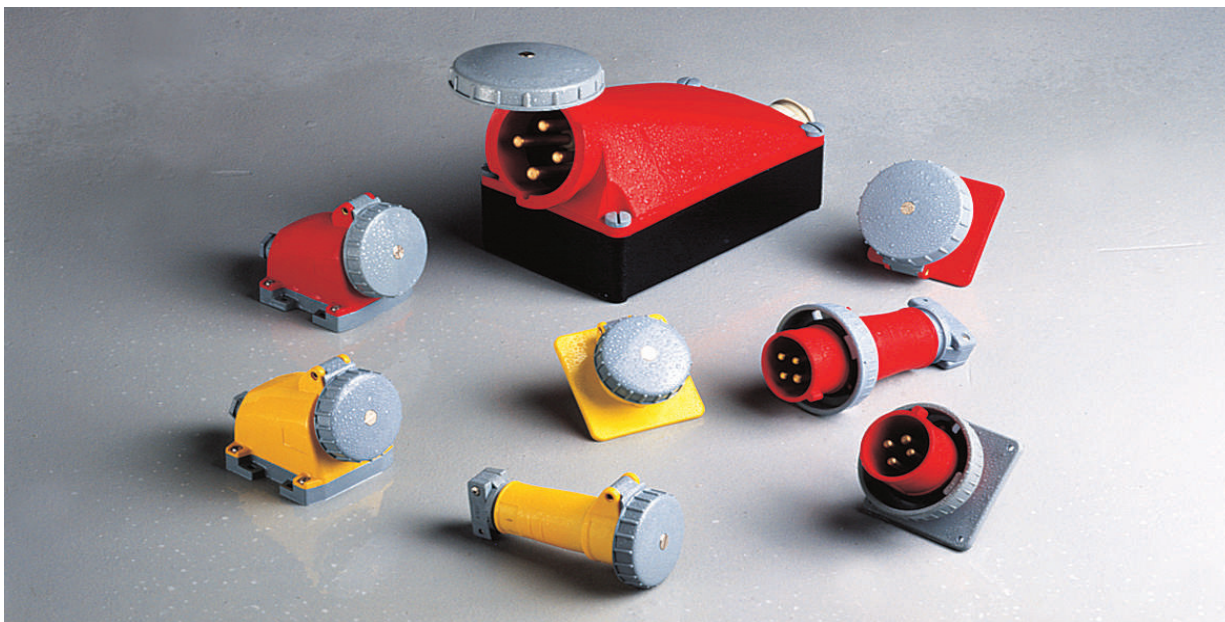

Características Gerais

Obs.: Dimensões e Desenhos no final da linha.

Matérias Primas:

Carcça, Alojamento, Prensa cabos e Aliviador de Tensão: Termo-plástico auto-extinguível (C.S.A. C.22.2 nº 6 e U.L. 94 HB-Mil spec 22096).
Tampa Trava-Subtampa e Arruela Trava: Poliamida 6.6.
Vedações e Guarnições: SBR (Neoprene sob consulta).
Terminais: Latão maciço.

Temperatura Operação:

0 / 120°C trabalho contínuo.
200°C (30 minutos).

Construção:

Conforme normas NBR IEC 60309-1, IEC 60309-2, DIN 49462, DIN 49463, CEE 17-BS4343 e VDE 0623 CE 127-12, NFC 63310 SEMKO 117.

Tensão máxima de trabalho:

690 Volts RMS - Conforme NBR IEC 60309-1

Identificação dos Terminais:

Conforme U.L., CSA e NBR IEC 60309

Fases	Neutro	Terra
1 - 2 - 3 R - S - T X - Y - Z L	N W	

Resistência ao Arco:

Conforme C.S.A. C22.2-182-1 (1990)
Altamente isolante (até 750V - 500Hz)

Rigidez Dielétrica: NBR IEC 60309-1

Tens. Nom.	Tens. Ensaio
Até 50V	500V
Até 415V	2.000V
Até 500V	2.500V
Acima de 500V	3.000V

Resistência ao Impacto:

Conforme C.S.A. C22.2 nº 182-1 parágrafos 7.4.2 e 7.4.4

Resistência à Abrasão:

Conforme C.S.A. C22.2 nº 182-1 parágrafos 7.4.3 e 7.4.4

Estanqueidade:

À prova d'água conforme C.S.A C22.2 - especificação 943 NBR IEC 60309-1 - 18(d)

Proteção Cabos:

Conforme C.S.A. C. nº 182-1 parágrafos 7.3

Tipo de Cabos:

Conforme U.L.62 e C.S.A.C22.2 nº 49

Resistências à Corrosão: (Partes Plásticas)

Salt Spray, Álcool, Óleo, Solventes, Lubrificantes, Graxas, Meios ácidos, Alcalinas e Outros Agentes Químicos.

Contatos Niquelados :





Acrescer NQ após o código

Linha: Plugues e Tomadas Blindadas à Prova D'água Shock Tite®

Produto	Amp.	Pólos	24V	110 / 130V	220 / 240V	380 / 440V	600V	Até 500Hz																					
Plugue  IP 67 Ligação nos contatos (mm²) <table border="1" data-bbox="215 604 598 694"> <thead> <tr> <th>Amp.</th> <th>16A</th> <th>32A</th> <th>63A</th> <th>125A</th> <th>200A</th> <th>250A</th> </tr> </thead> <tbody> <tr> <td>Mín.</td> <td>2,5</td> <td>4,0</td> <td>10,0</td> <td>35,0</td> <td>-</td> <td>-</td> </tr> <tr> <td>Máx.</td> <td>4,0</td> <td>6,0</td> <td>16,0</td> <td>70,0</td> <td>95,0</td> <td>95,0</td> </tr> </tbody> </table>	Amp.	16A	32A	63A	125A	200A	250A	Mín.	2,5	4,0	10,0	35,0	-	-	Máx.	4,0	6,0	16,0	70,0	95,0	95,0	16	3	S3072W	S3074W	S3076W	S3079W	S3075W	S3070W
	Amp.	16A	32A	63A	125A	200A	250A																						
	Mín.	2,5	4,0	10,0	35,0	-	-																						
	Máx.	4,0	6,0	16,0	70,0	95,0	95,0																						
	16	4	S4072W	S4074W	S4079W	S4076W	S4075W	S4070W																					
	16	5	S5072W	S5074W	S5079W	S5076W	S5075W	S5070W																					
	32	3	S3272W	S3274W	S3276W	S3279W	S3275W	S3270W																					
	32	4	S4272W	S4274W	S4279W	S4276W	S4275W	S4270W																					
	32	5	S5272W	S5274W	S5279W	S5276W	S5275W	S5270W																					
	63	3	S3572W	S3574W	S3576W	S3579W	S3575W	S3570W																					
	63	4	S4572W	S4574W	S4579W	S4576W	S4575W	S4570W																					
	63	5	S5572W	S5574W	S5579W	S5576W	S5575W	S5570W																					
	125	3	S3672W	S3674W	S3676W	S3679W	S3675W	S3670W																					
	125	4	S4672W	S4674W	S4679W	S4676W	S4675W	S4670W																					
	125	5	S5672W	S5674W	S5679W	S5676W	S5675W	S5670W																					
	200	3	S3872W	S3874W	S3876W	S3879W	S3875W	S3870W																					
	200	4	S4872W	S4874W	S4879W	S4876W	S4875W	S4870W																					
	200	5	S5872W	S5874W	S5879W	S5876W	S5875W	S5870W																					
	250	4	S6872W	S6874W	S6879W	S6876W	S6875W	S6870W																					
	Tomada de sobrepôr  IP 67 Opção c/ rosca GAS (*) Ligação nos contatos (mm²) <table border="1" data-bbox="383 974 542 1064"> <thead> <tr> <th>Amp.</th> <th>16A</th> <th>32A</th> </tr> </thead> <tbody> <tr> <td>Mín.</td> <td>2,5</td> <td>4,0</td> </tr> <tr> <td>Máx.</td> <td>4,0</td> <td>6,0</td> </tr> </tbody> </table>	Amp.	16A	32A	Mín.	2,5	4,0	Máx.	4,0	6,0	16	3	S3002W	S3004W	S3006W	S3009W	S3005W	S3000W											
Amp.		16A	32A																										
Mín.		2,5	4,0																										
Máx.		4,0	6,0																										
16		4	S4002W	S4004W	S4009W	S4006W	S4005W	S4000W																					
16		5	S5002W	S5004W	S5009W	S5006W	S5005W	S5000W																					
32		3	S3202W	S3204W	S3206W	S3209W	S3205W	S3200W																					
32	4	S4202W	S4204W	S4209W	S4206W	S4205W	S4200W																						
32	5	S5202W	S5204W	S5209W	S5206W	S5205W	S5200W																						
Tomada de sobrepôr  IP 67 Opção c/ rosca GAS (*) Ligação nos contatos (mm²) <table border="1" data-bbox="383 1198 494 1276"> <thead> <tr> <th>Amp.</th> <th>63A</th> </tr> </thead> <tbody> <tr> <td>Mín.</td> <td>10,0</td> </tr> <tr> <td>Máx.</td> <td>16,0</td> </tr> </tbody> </table>	Amp.	63A	Mín.	10,0	Máx.	16,0	63	3	S3502W	S3504W	S3506W	S3509W	S3505W	S3500W															
	Amp.	63A																											
	Mín.	10,0																											
	Máx.	16,0																											
63	4	S4502W	S4504W	S4509W	S4506W	S4505W	S4500W																						
63	5	S5502W	S5504W	S5509W	S5506W	S5505W	S5500W																						
Tomada de sobrepôr  IP 67 Opção c/ rosca GAS (*) Ligação nos contatos (mm²) <table border="1" data-bbox="383 1411 598 1500"> <thead> <tr> <th>Amp.</th> <th>125A</th> <th>200A</th> <th>250A</th> </tr> </thead> <tbody> <tr> <td>Mín.</td> <td>35,0</td> <td>-</td> <td>-</td> </tr> <tr> <td>Máx.</td> <td>70,0</td> <td>95,0</td> <td>95,0</td> </tr> </tbody> </table>	Amp.	125A	200A	250A	Mín.	35,0	-	-	Máx.	70,0	95,0	95,0	125	3	S3602W	S3604W	S3606W	S3609W	S3605W	S3600W									
	Amp.	125A	200A	250A																									
	Mín.	35,0	-	-																									
	Máx.	70,0	95,0	95,0																									
	125	4	S4602W	S4604W	S4609W	S4606W	S4605W	S4600W																					
	125	5	S5602W	S5604W	S5609W	S5606W	S5605W	S5600W																					
	200	4	S4802W	S4804W	S4809W	S4806W	S4805W	S4800W																					
200	5	S5802W	S5804W	S5809W	S5806W	S5805W	S5800W																						
250	4	S6802W	S6804W	S6809W	S6806W	S6805W	S6800W																						
						S4901W																							
Tomada de embutir  IP 67 Ligação nos contatos (mm²) <table border="1" data-bbox="231 1758 606 1848"> <thead> <tr> <th>Amp.</th> <th>16A</th> <th>32A</th> <th>63A</th> <th>125A</th> <th>200A</th> <th>250A</th> </tr> </thead> <tbody> <tr> <td>Mín.</td> <td>2,5</td> <td>4,0</td> <td>10,0</td> <td>35,0</td> <td>-</td> <td>-</td> </tr> <tr> <td>Máx.</td> <td>4,0</td> <td>6,0</td> <td>16,0</td> <td>70,0</td> <td>95,0</td> <td>95,0</td> </tr> </tbody> </table>	Amp.	16A	32A	63A	125A	200A	250A	Mín.	2,5	4,0	10,0	35,0	-	-	Máx.	4,0	6,0	16,0	70,0	95,0	95,0	16	3	S3042W	S3044W	S3046W	S3049W	S3045W	S3040W
	Amp.	16A	32A	63A	125A	200A	250A																						
	Mín.	2,5	4,0	10,0	35,0	-	-																						
	Máx.	4,0	6,0	16,0	70,0	95,0	95,0																						
	16	4	S4042W	S4044W	S4049W	S4046W	S4045W	S4040W																					
	16	5	S5042W	S5044W	S5049W	S5046W	S5045W	S5040W																					
	32	3	S3242W	S3244W	S3246W	S3249W	S3245W	S3240W																					
	32	4	S4242W	S4244W	S4249W	S4246W	S4245W	S4240W																					
	32	5	S5242W	S5244W	S5249W	S5246W	S5245W	S5240W																					
	63	3	S3542W	S3544W	S3546W	S3549W	S3545W	S3540W																					
	63	4	S4542W	S4544W	S4549W	S4546W	S4545W	S4540W																					
	63	5	S5542W	S5544W	S5549W	S5546W	S5545W	S5540W																					
	125	3	S3642W	S3644W	S3646W	S3649W	S3645W	S3640W																					
	125	4	S4642W	S4644W	S4649W	S4646W	S4645W	S4640W																					
	125	5	S5642W	S5644W	S5649W	S5646W	S5645W	S5640W																					
200	4	S4842W	S4844W	S4849W	S4846W	S4845W	S4840W																						
200	5	S5842W	S5844W	S5849W	S5846W	S5845W	S5840W																						
250	5	S6842W	S6844W	S6849W	S6846W	S6845W	S6840W																						

Para Contatos Niquelados acrescentar NQ após o código
 (*) para rosca Gas verificar adaptadores página 67

Linha: Plugues e Tomadas Blindadas à Prova D'água Shock Tite®

Produto	Amp.	Pólos	24V	110 / 130V	220 / 240V	380 / 440V	600V	Até 500Hz																					
Plugue Fixo de embutir (inlet) IP67  <p>Ligação nos contatos (mm²)</p> <table border="1"> <thead> <tr> <th>Amp.</th> <th>16A</th> <th>32A</th> <th>63A</th> <th>125A</th> <th>200A</th> <th>250A</th> </tr> </thead> <tbody> <tr> <td>Mín.</td> <td>2,5</td> <td>4,0</td> <td>10,0</td> <td>35,0</td> <td>-</td> <td>-</td> </tr> <tr> <td>Máx.</td> <td>4,0</td> <td>6,0</td> <td>16,0</td> <td>70,0</td> <td>95,0</td> <td>95,0</td> </tr> </tbody> </table> <p>Uso exclusivo c/ acoplamento Shock Tite</p>	Amp.	16A	32A	63A	125A	200A	250A	Mín.	2,5	4,0	10,0	35,0	-	-	Máx.	4,0	6,0	16,0	70,0	95,0	95,0	16	3	S3032W	S3034W	S3036W	S3039W	S3035W	S3030W
	Amp.	16A	32A	63A	125A	200A	250A																						
	Mín.	2,5	4,0	10,0	35,0	-	-																						
	Máx.	4,0	6,0	16,0	70,0	95,0	95,0																						
	16	4	S4032W	S4034W	S4039W	S4036W	S4035W	S4030W																					
	16	5	S5032W	S5034W	S5039W	S5036W	S5035W	S5030W																					
	32	3	S3232W	S3234W	S3236W	S3239W	S3235W	S3230W																					
	32	4	S4232W	S4234W	S4239W	S4236W	S4235W	S4230W																					
	32	5	S5232W	S5234W	S5239W	S5236W	S5235W	S5230W																					
	63	3	S3532W	S3534W	S3536W	S3539W	S3535W	S3530W																					
	63	4	S4532W	S4534W	S4539W	S4536W	S4535W	S4530W																					
	63	5	S5532W	S5534W	S5539W	S5536W	S5535W	S5530W																					
	125	3	S3632W	S3634W	S3636W	S3639W	S3635W	S3630W																					
	125	4	S4632W	S4634W	S4639W	S4636W	S4635W	S4630W																					
	125	5	S5632W	S5634W	S5639W	S5636W	S5635W	S5630W																					
	200	3	S3832W	S3834W	S3836W	S3839W	S3835W	S3830W																					
	200	4	S4832W	S4834W	S4839W	S4836W	S4835W	S4830W																					
	200	5		S5834W	S5839W	S5836W	S5835W																						
	250	4					S4931W																						
	Acoplamento (extensão) IP67  <p>Ligação nos contatos (mm²)</p> <table border="1"> <thead> <tr> <th>Amp.</th> <th>16A</th> <th>32A</th> <th>63A</th> <th>125A</th> <th>200A</th> <th>250A</th> </tr> </thead> <tbody> <tr> <td>Mín.</td> <td>2,5</td> <td>4,0</td> <td>10,0</td> <td>35,0</td> <td>-</td> <td>-</td> </tr> <tr> <td>Máx.</td> <td>4,0</td> <td>6,0</td> <td>16,0</td> <td>70,0</td> <td>95,0</td> <td>95,0</td> </tr> </tbody> </table>	Amp.	16A	32A	63A	125A	200A	250A	Mín.	2,5	4,0	10,0	35,0	-	-	Máx.	4,0	6,0	16,0	70,0	95,0	95,0	16	3	S3052W	S3054W	S3056W	S3059W	S3055W
Amp.		16A	32A	63A	125A	200A	250A																						
Mín.		2,5	4,0	10,0	35,0	-	-																						
Máx.		4,0	6,0	16,0	70,0	95,0	95,0																						
16		4	S4052W	S4054W	S4059W	S4056W	S4055W	S4050W																					
16		5	S5052W	S5054W	S5059W	S5056W	S5055W	S5050W																					
32		3	S3252W	S3254W	S3256W	S3259W	S3255W	S3250W																					
32		4	S4252W	S4254W	S4259W	S4256W	S4255W	S4250W																					
32		5	S5252W	S5254W	S5259W	S5256W	S5255W	S5250W																					
63		3	S3552W	S3554W	S3556W	S3559W	S3555W	S3550W																					
63		4	S4552W	S4554W	S4559W	S4556W	S4555W	S4550W																					
63		5	S5552W	S5554W	S5559W	S5556W	S5555W	S5550W																					
125		3	S3652W	S3654W	S3656W	S3659W	S3655W	S3650W																					
125		4	S4652W	S4654W	S4659W	S4656W	S4655W	S4650W																					
125		5	S5652W	S5654W	S5659W	S5656W	S5655W	S5650W																					
200	3	S3852W	S3854W	S3856W	S3859W	S3855W	S3850W																						
200	4	S4852W	S4854W	S4859W	S4856W	S4855W	S4850W																						
200	5		S5854W	S5859W	S5856W	S5855W																							
250	4					S4951W																							
Tampa de Proteção para Plugs À prova d'água 	16	3			S61330																								
	16	4			S61340																								
	16	5			S61350																								
	32	3/4			S63340																								
	32	5			S63350																								
	63	3/4/5			S66350																								
	125	3/4/5																											
200/250	3/4/5			S67350																									
Tomada de Embutir - IP 65 com flange 4x4 para cozinha industrial 	Amp.	Pólos	110 / 130V		220 / 240V		380 / 440V																						
	16	3	S10700075		S10700050		S10700055																						
	16	4	S10700115		S10700104		S10700056																						
	16	5	S10700118		S10700120		S10700119																						
	32	3	S10700110		S10700109		S10700057																						
	32	4	S10700116		S10700117		S10700058																						
32	5	S10700121		S10700123		S10700122																							

Para Contatos Niquelados acrescentar NQ após o código

Linha: Plugues e Tomadas Blindadas à Prova D'água Shock Tite®

São os únicos Plugues e Tomadas fabricados no Brasil para uso específico em Containers Eletrificados. Seguem as principais normas internacionais, sendo utilizados em todos os portos do mundo.

Características
IP 67 3P+T 32A 380/440V 3H

Plugues e Tomadas para Containers

Tomada de Sobrepor Bloqueio Mecânico



SS4203B
SS4203D (com disjuntor)
SS4203DZ (com diazed)

Tomada de Sobrepor Compacta



SS4203TW

Tomada de Embutir Compacta



SS4243TW

Plugue



S4273W

Acoplamento



S4253W

Tomada de Sobrepor



S4203W

Tomada de Embutir



S4243W

Plugue Fixo de Embutir (inlet)



S4233W

Para Contatos Niquelados acrescentar NQ após o código / Para rosca Gas verificar adaptadores na página 67

Linha: Plugues e Tomadas Blindadas à Prova D'água Shock Tite®

Dimensões e Desenhos Técnicos

Plugue Shock-Tite® 16A até 250A

Corrente	16A			32A			63A			125A			200A			250A			
	Pólos	3	4	5	3	4	5	3	4	5	3	4	5	3	4	5	3	4	5
A	43,5	49,5	56,1	57,3	57,3	63,4	69,5	69,5	69,5	81,5	81,5	81,5	81,5	81,5	81,5	81,5	81,5	81,5	81,5
B	149,0	149,0	175,0	183,0	183,0	205,0	252,0	252,0	252,0	326,0	326,0	326,0	326,0	326,0	326,0	326,0	326,0	326,0	326,0
C	69,0	77,5	89,0	95,0	95,0	102,0	14,0	14,0	14,0	124,0	124,0	124,0	124,0	124,0	124,0	124,0	124,0	124,0	124,0
D	45,0	45,0	45,0	52,0	52,0	52,0	72,5	72,5	72,5	86,0	86,0	86,0	86,0	86,0	86,0	86,0	86,0	86,0	86,0
Rosca BSP	1"	1"	1 1/4"	1 1/4"	1 1/4"	1 1/2"	1 1/2"	1 1/2"	1 1/2"	2 2/4"	2 2/4"	2 2/4"	2 2/4"	2 2/4"	2 2/4"	2 2/4"	2 2/4"	2 2/4"	2 2/4"
Ø Cabo	Min.	18,0	18,0	22,0	22,0	22,0	32,0	32,0	32,0	37,0	37,0	37,0	37,0	37,0	37,0	37,0	37,0	37,0	37,0
	Máx.	25,0	25,0	32,0	32,0	32,0	38,0	38,0	38,0	44,0	44,0	44,0	44,0	44,0	44,0	44,0	44,0	44,0	44,0

16A / 32A / 63A / 125A / 200A / 250A

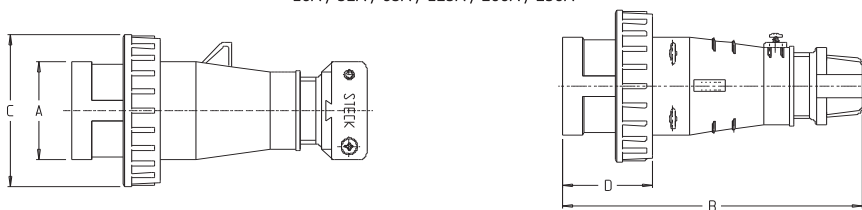

Plugue fixo de embutir Shock-Tite® 16A até 250A

Corrente	16A			32A			63A			125A			200A			250A			
	Pólos	3	4	5	3	4	5	3	4	5	3	4	5	3	4	5	3	4	5
A	95,2	95,2	95,2	95,2	95,2	95,2	114,6	114,6	114,6	139,7	139,7	139,7	139,7	139,7	139,7	139,7	139,7	139,7	139,7
B	95,2	95,2	95,2	95,2	95,2	95,2	114,6	114,6	114,6	139,7	139,7	139,7	139,7	139,7	139,7	139,7	139,7	139,7	139,7
C	84,5	84,5	99,5	100,5	100,5	103,5	135,5	135,5	135,5	158,2	158,2	158,2	158,2	158,2	158,2	158,2	158,2	158,2	158,2
D	79,4	79,4	79,4	79,4	79,4	79,4	98,4	98,4	98,4	123,8	123,8	123,8	123,8	123,8	123,8	123,8	123,8	123,8	123,8
E	79,4	79,4	79,4	79,4	79,4	79,4	98,4	98,4	98,4	123,8	123,8	123,8	123,8	123,8	123,8	123,8	123,8	123,8	123,8
ØG	49,5	49,5	61,5	63,0	63,0	63,0	76,0	76,0	76,0	88,0	88,0	88,0	88,0	88,0	88,0	88,0	88,0	88,0	88,0
ØH	4,5	4,5	4,5	4,5	4,5	4,5	4,5	4,5	4,5	4,5	4,5	4,5	4,5	4,5	4,5	4,5	4,5	4,5	4,5

16A / 32A / 63A / 125A / 200A / 250A

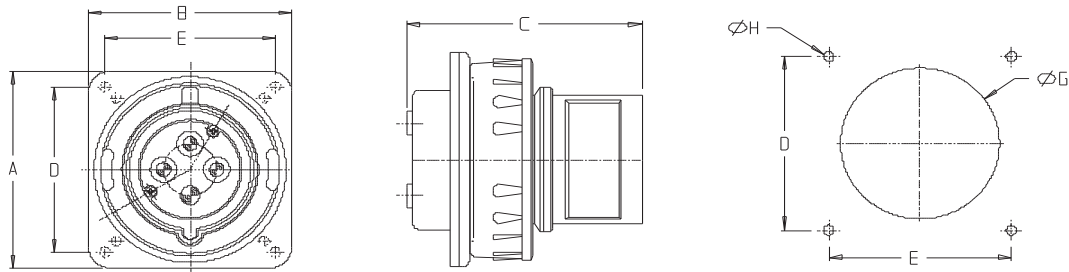

Linha: Plugues e Tomadas Blindadas à Prova D'água Shock Tite®

®

Dimensões e Desenhos Técnicos

Tomada de Sobrepor Shock-Tite® 16A até 250A

Corrente	16A			32A			63A			125A			200A			250A			
	Pólos	3	4	5	3	4	5	3	4	5	3	4	5	3	4	5	3	4	5
A	91,0	91,0	91,0	102,0	102,0	102,0	121,0	121,0	121,0	160,0	160,0	160,0	160,0	160,0	160,0	160,0	160,0	160,0	160,0
B	143,0	143,0	143,0	180,0	180,0	180,0	252,0	252,0	252,0	344,0	344,0	344,0	344,0	344,0	344,0	344,0	344,0	344,0	344,0
C	108,0	108,0	108,0	131,0	131,0	131,0	125,0	125,0	125,0	192,0	192,0	192,0	192,0	192,0	192,0	192,0	192,0	192,0	192,0
D	79,0	79,0	79,0	90,0	90,0	90,0	85,0	85,0	85,0	139,0	139,0	139,0	139,0	139,0	139,0	139,0	139,0	139,0	139,0
E	42,0	42,0	42,0	68,0	68,0	68,0	105,0	105,0	105,0	240,0	240,0	240,0	240,0	240,0	240,0	240,0	240,0	240,0	240,0
F	-	-	-	-	-	-	122,0	122,0	122,0	-	-	-	-	-	-	-	-	-	-
Rosca PG	16	16	16	21,0	21,0	21,0	29	29	29	-	-	-	-	-	-	-	-	-	-
Rosca BSP	-	-	-	-	-	-	-	-	-	1 1/2"	1 1/2"	1 1/2"	1 1/2"	1 1/2"	1 1/2"	1 1/2"	1 1/2"	1 1/2"	1 1/2"
Ø Cabo	Min.	10	10	10	13,0	13,0	13,0	18,0	18,0	18,0	32,0	32,0	32,0	32,0	32,0	32,0	32,0	32,0	32,0
	Máx.	14,0	14,0	14,0	18,0	18,0	18,0	13,0	13,0	13,0	38,0	38,0	38,0	38,0	38,0	38,0	38,0	38,0	38,0

16A / 32A

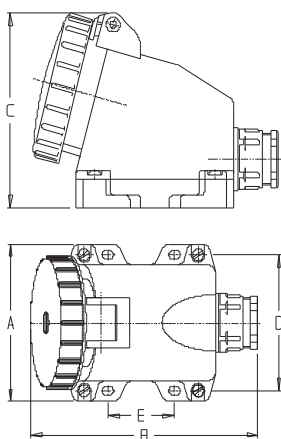

63A

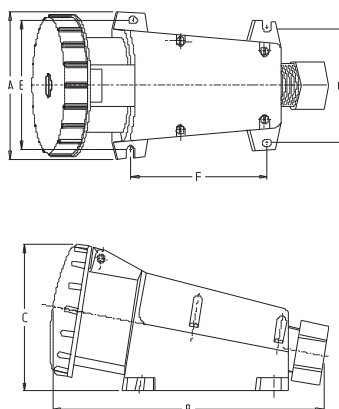

125A / 200A

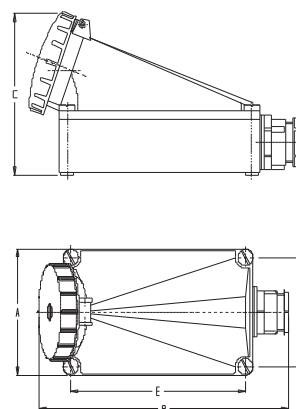

Acoplamento Shock-Tite® 16A até 250A

Corrente	16A			32A			63A			125A			200A			250A			
	Pólos	3	4	5	3	4	5	3	4	5	3	4	5	3	4	5	3	4	5
A	74,3	82,3	91,0	95,2	95,2	104,0	112,0	112,0	112,0	112,0	112,0	112,0	112,0	112,0	112,0	112,0	112,0	112,0	112,0
B	160,0	160,0	183,0	193,0	193,0	215,0	270,0	270,0	270,0	270,0	270,0	270,0	270,0	270,0	270,0	270,0	270,0	270,0	270,0
C	78,9	89,2	98,7	99,6	99,6	110,5	114,5	114,5	114,5	114,5	114,5	114,5	114,5	114,5	114,5	114,5	114,5	114,5	114,5
Rosca BSP	1"	1"	1 1/4"	1 1/4"	1 1/4"	1 1/2"	1 1/2"	1 1/2"	1 1/2"	1 1/2"	1 1/2"	1 1/2"	1 1/2"	1 1/2"	1 1/2"	1 1/2"	1 1/2"	1 1/2"	1 1/2"
Ø Cabo	Min.	18,0	18,0	22,0	22,0	22,0	32,0	32,0	32,0	32,0	32,0	32,0	32,0	32,0	32,0	32,0	32,0	32,0	32,0
	Máx.	25,0	25,0	32,0	32,0	38,0	38,0	38,0	38,0	38,0	38,0	38,0	38,0	38,0	38,0	38,0	38,0	38,0	38,0

16A / 32A / 63A / 125A / 200A / 250A

